

The **Smith Meter™ Model ST-160** is a DN80 (3") single-case, straight-through, rotary vane positive displacement meter commonly used on tank trucks and as a line meter. Applications include: blending, batching, dispensing, inventory control and custody transfer of oils, solvents, chemicals, paints, fats, and fertilizers.

#### Features

- **Superior Accuracy** - The Smith Rotary Vane Meter principle and unique offset, inlet, and outlet nozzles combine to minimize pressure drop across the measuring chamber for reduced flow through the meter clearances for maximum accuracy.
- **Low Pressure Drop** - Streamlined flow path provides low pressure drop.
- **Positive and Accurate Registration** - High torque drive calibrator with adjustments in 0.05% increments ensures accurate registration.
- **Long Service Life** - Low friction ball bearings, fixed cam timing, and rugged construction give sustained accuracy and long life.
- **Ductile Iron Housing** - for a maximum working pressure of 16 bar.
- **PED** - Liquid Compliant

#### Options

- **High Viscosity Meter Clearances** - to extend operation at maximum flow rate above 400 mPa•s to 2,000 mPa•s.
- **High Temperature Meter Clearances** - to extend operating temperatures from 65°C to 93°C.
- **Viton** - increase application flexibility.
- **All Iron Construction** - for operating temperatures above 93°C.
- **Load Rack Trim** - For low lubricity products.
- **End Connections** - Available with DIN or ANSI flanges.

#### Operating Specifications

<b>Maximum Flow Rate</b>	USGPM	L/min
Continuous Rating - Standard Trim	320	1200
Intermittent Rating <sup>1</sup> - Standard Trim	425	1600
Continuous/Intermittent Rating - All Iron or LPG Trim	245	925



Model ST-160-DI

#### Minimum Flow Rate - Typical Performance

Linearity <sup>2</sup>	Units	Viscosity (mPa•s)					
		0.5	1	5	20	100	400
±0.15%	USGPM	50	30	12	3.0	0.60	0.15
	L/min	190	113	45	11.3	2.30	0.57
±0.25%	USGPM	40	22	9	2.2	0.45	0.11
	L/min	150	83	34	8.3	1.70	0.42
±0.50%	USGPM	25	15	6	1.5	0.30	0.08
	L/min	95	57	23	5.7	1.10	0.30

#### Repeatability

± 0.02%

#### Viscosity

Standard: 400 mPa•s<sup>3</sup> (2,000 SSU) maximum.

Optional: 2 Pa•s (10,000 SSU) maximum - specify "High Viscosity Meter Clearances."

Over 2 Pa•s: Specify "High Viscosity Meter Clearances" and derate maximum flow rate in direct proportion to viscosity over 2 Pa•s (e.g., at 4 Pa•s, derate maximum flow rate to 50% of normal continuous rating - 600 L/min).

#### Notes:

<sup>1</sup> Intermittent rating applies to service on clean, refined products where continuous operation is not required (e.g., truck loading, rail loading, and other batching applications).

<sup>2</sup> Linearity based on a maximum flow rate of 320 USGPM (1200 L/min).

<sup>3</sup> 1,000 mPa•s = 1,000 cP = 1 Pa•s

## Temperature

### Standard Meter Clearances, with -

- Buna-N: -20°C to 65°C (-4°F to 150°F)
- Viton seals: -12°C to 65°C (10°F to 150°F)

### High Temperature Meter Clearances, with -

- Buna-N: -20°C to 93°C (-4°F to 200°F)
- Viton seals: -12°C to 93°C (10°F to 200°F)

### All Iron Trim, with -

- Buna N seals: -20°C to 108°C (-4°F to 225°F)
- Viton seals: -12°C to 150°C (10°F to 300°F)

### Optional Low Temperature:

-29°C (-20°F) at reduced working pressure of 10 bar (1,000 kPa), with Buna-N Seals.  
Special low temperature of -40°C (-40°F) on request.

## Meter Gearing

One dekalitre per revolution of meter calibrator output shaft.

## End Connections and Maximum Working Pressure

End Connections	Housing Material	Pressure - bar (kPa)
Class 150 ANSI B16.42 raised face flanges DIN EN PN16 raised face flange	Ductile Iron	16 (1,600)

## Materials of Construction

Housing	Internals	Seals
Ductile Iron	Iron, Steel, Stainless Steel, Aluminum  Optional: All Iron	Buna  Optional: Viton

## Installation

It is recommended that the meter be protected with a 40 mesh strainer.

## Strainer Specifications

Type	End Connections	Housing Material	Pressure - bar (kPa)
80-E20	Class 150 ANSI B16.5 raised face flanges	Cast Steel	19.7 (1,965)
	DIN EN PN16 raised face flanges		16 (1,600)

## Meter Ordering Information

<b>Application</b>	Batching, Loading, Blending, Inventory, Process Control, etc.
<b>Operating Conditions</b>	<b>Liquid</b> - Name, Viscosity (Min./Max.), and Specific Gravity <b>Flow Range</b> - Min./Norm./Max. <b>Temperature Range</b> - Min./Max. <b>Maximum Working Pressure</b>
<b>Units of Registration</b>	Litres, Dekalitres, Gallons, Kilograms, or Pounds
<b>Options</b>	<b>Seals</b> - Buna, or Viton <b>Internal Construction</b> - Iron/Aluminum, All Iron <b>Clearances</b> - Standard, High Viscosity, or High Temperature <b>End Connections</b> - ANSI or DIN
<b>Accessories</b>	As required, see below.

## Pressure Drop

A - Strainer - 40 Mesh  
 B - Meter  
 C - Preset Valve

To approximate pressure drop for strainers with other than 40 mesh baskets, multiply chart reading by the appropriate factor.

Mesh	Factor
4	.65
10	.75
20	.85
80	1.25

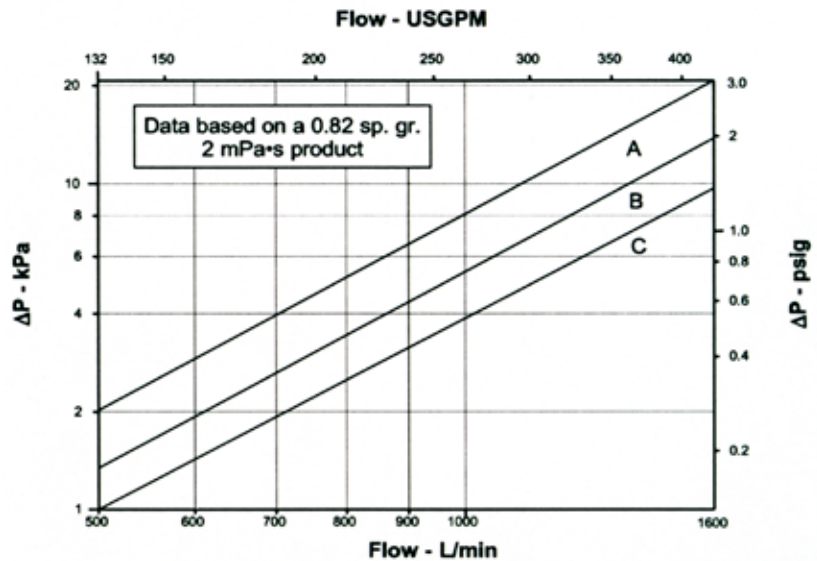

## Accessories

### Strainers

**Housing Material** - Cast Steel

**Seals** - Buna (standard), or Viton.

**Liner** - 40 (standard), 4, 10, 20, or 80 mesh.

**Options** - RB-Type Air Release Kit.

### Deaerator

**Type** - Vertical or horizontal

**Housing Material** - Steel

**Seals** - Buna (standard), or Viton.

### Hydraulic Valves

**Type** - Globe-type

**Housing Material** - Cast Steel

### Mechanical Set Stop Valves

**Type** - Straight-Through.

**Housing Material** - Steel

**Seals** - Buna (standard), Viton.

### Automatic Temperature Compensation

**Model ATC** - Factory-set for a given product.

**Model ATG** - Field-adjustable for different products.

### Counters

**200 Series** - Accumulative, nine-digit, non-reset type.

**600 Series** - Five large-digit reset, eight small-digit non-reset.

### Printers

Seven-digit accumulative.

Optional six-digit zero-start.

### Preset Counters

**300C Series** - Five-digit mechanical pushbutton preset with valve linkage. Microswitch package for pump control or other interlock optional.

### Pulse Transmitters

**GPST** - Dual-channel, photoelectric transmitter to ATEX (EEx)d IIB T6. Maximum output 500 pulses/revolution.

**LNC Transmitter** (Adapts to new-style 600 Series Counter) - Low Resolution: 1 or 10 pulses/revolution of counter R.H. Wheel. ATEX approved (EEx)d IIA T6.

High Resolution (HR): 100 or 50 pulses/revolution of counter R.H. Wheel. ATEX approved (EEx)d IIA T6.

**PE-P Portable Photoelectric Transmitter** - General purpose enclosure. Requires Right-Angle-Drive on meter.

**UPT** - Universal Pulse Transmitter.

ATEX approved (EEx)d IIB T6.

Max output 1000 pulses/revolution

### Flow Rate Indicators

Direct mount mechanical.

Remote electronic.

### Remote Registration

Electromechanical counters.

Electronic totalizers.

Load printer.

## Dimensions<sup>5</sup>

Millimetres (Inches)

### Meter ST-160-DI with Accessories

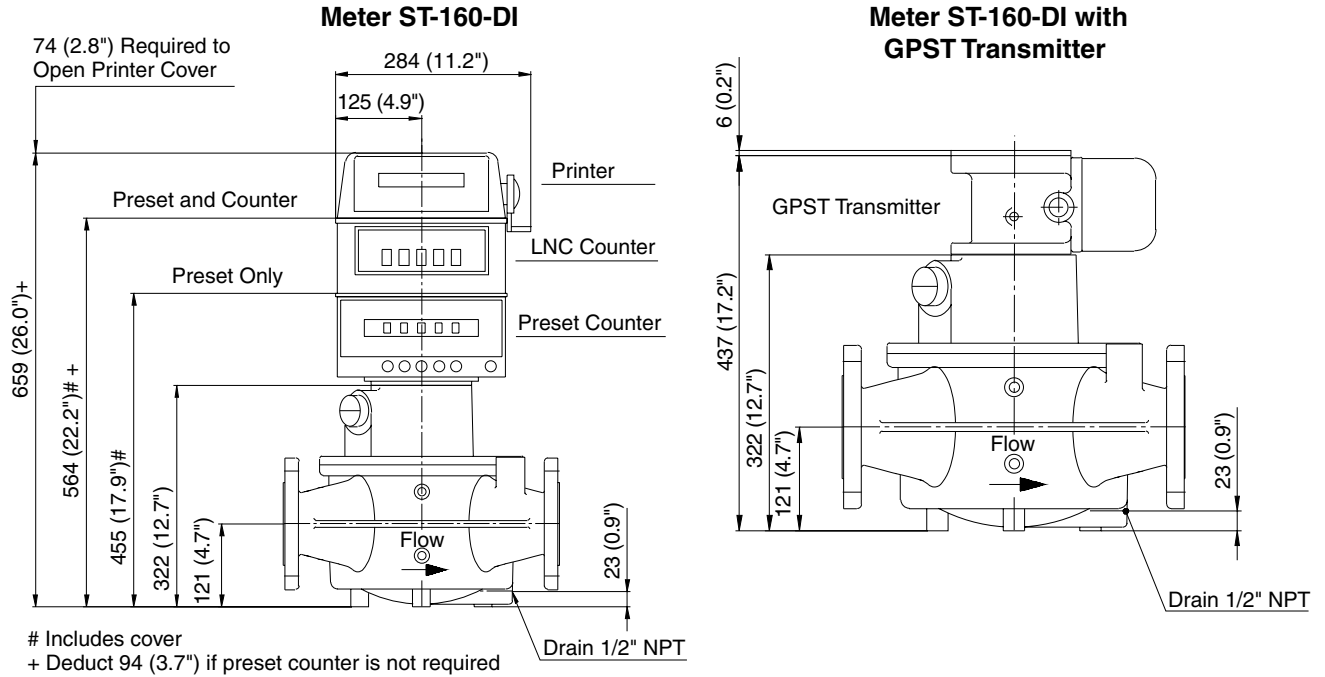

### Meter Mounting Bolt Holes

3-M10 Threaded Bolt Holes,  
Equally Spaced on a  
206 mm (8.1") Diameter Bolt Circle

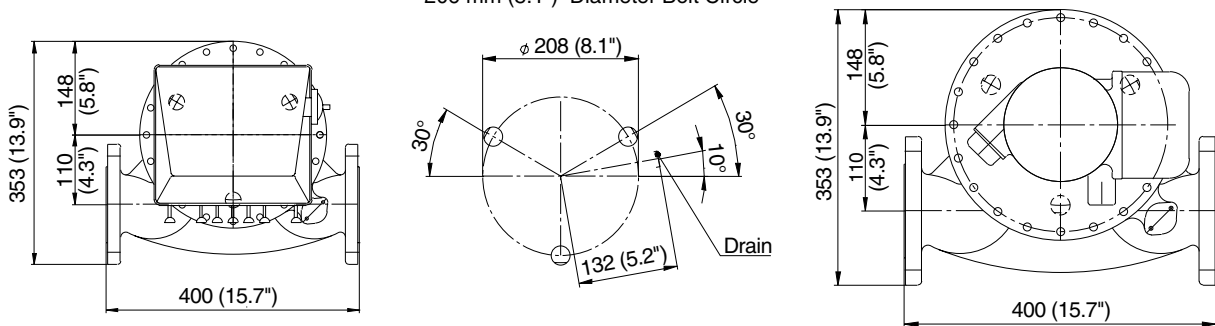

### Notes:

<sup>5</sup> Dimensions — Millimetres to the nearest whole mm (inches to the nearest tenth), each independently dimensioned from respective engineering drawings.

The specifications contained herein are subject to change without notice and any user of said specifications should verify from the manufacturer that the specifications are currently in effect. Otherwise, the manufacturer assumes no responsibility for the use of specifications which may have been changed and are no longer in effect.

### Headquarters:

1803 Gears Road, Houston, TX 77067 USA, Phone: 281/260-2190, Fax: 281/260-2191

### Gas Measurement Products:

Houston, TX USA Phone 281/260-2190

Thetford, England Phone (44) 1842-82-2900

Kongsberg, Norway Phone (47) 32/286-700

Buenos Aires, Argentina Phone 54 (11) 4312-4736

### Integrated Measurement Systems:

Corpus Christi, TX USA Phone 361/289-3400

Kongsberg, Norway Phone (47) 32/286-700

San Juan, Puerto Rico Phone 787/274-3760

United Arab Emirates, Dubai Phone 971 +4/331-3646

### Liquid Measurement Products:

Erie, PA USA Phone 814/898-5000

Los Angeles, CA USA Phone 661/702-8660

Slough, England Phone (44) 1753-57-1515

Ellerbek, Germany Phone (49) 4101-3040

Barcelona, Spain Phone (34) 93/201-0989

Moscow, Russia Phone (7) 495/564-8705

Melbourne, Australia Phone (61) 3/9807-2818

Beijing, China Phone (86) 10/6500-2251

Singapore Phone (65) 6861-3011

Chennai, India Phone (91) 44/450-4400

Visit our website at [www.fmctechnologies.com](http://www.fmctechnologies.com)