

The **Smith Meter® Model SC-13 Meter** is a 2", single-case, straight-through type, rotary vane, positive displacement meter. Applications include: blending, batching, dispensing, inventory control, and custody transfer of oils, solvents, chemicals, paints, fats, and fertilizers.

### Features

- **Superior Accuracy** - Since the unrestricted flow path results in minimal pressure drop across the measuring chamber, slippage through meter clearances is minimized and accuracy maximized.
- **Low Pressure Drop** - Low velocities and streamlined flow path provides the lowest pressure drop PD meter in the industry.
- **Positive and Accurate Registration** - High torque drive calibrator ensures accurate registration and adjustment in 0.05% increments.
- **Long Service Life** - Low friction ball bearings, fixed cam-type timing, and rugged construction give sustained accuracy and long service life.
- **Extended Flow Turndown** - NCWM approved for use from 3 to 150 GPM; an ideal solution for biofuel blending (see NTEP Certificate 95-054A4).

### Operating Specifications

#### Maximum Flow Rate

	USGPM	L/min
Continuous Rating - Standard Trim	125	475
Intermittent Rating <sup>1</sup> - Standard Trim	150	570
Continuous/Intermittent Rating - All Iron	100	375

#### Minimum Flow Rate — Typical Performance

Linearity <sup>2</sup>	Units	Viscosity (Centipoise - cP)					
		0.5	1	5	20	100	400
±0.15%	USGPM	25	15	6	1.5	0.30	0.08
	L/min	95	57	23	6.0	1.00	0.30
±0.25%	USGPM	17	10	4	1.0	0.20	0.05
	L/min	65	38	15	4.0	0.75	0.20
±0.50%	USGPM	13	8	3	0.8	0.16	0.04
	L/min	50	30	11	3.0	0.60	0.15

#### Repeatability

±0.02%

<sup>1</sup> Intermittent rating applies to service on clean, refined products where continuous operation is not required (e.g., truck loading, rail loading, and other batching applications).

<sup>2</sup> Based on a maximum flow rate of 125 USGPM (475 L/min).



**SC-13 Meter with Mechanical Preset Package**

#### Viscosity

Standard: 400 cP (2,000 SSU) maximum.

Optional: 2,000 cP (10,000 SSU) maximum - specify "High Viscosity Meter Clearances."

Over 2,000 cP: Specify "High Viscosity Meter Clearances" and derate maximum flow rate in direct proportion to viscosity over 2,000 cP (e.g., at 4,000 cP, derate maximum flow rate to 50% of normal continuous rating - 63 USGPM).

#### Temperature

Standard Meter Clearances With:

Viton: 10°F to 150°F (-12°C to 65°C).

Teflon: -20°F to 150°F (-29°C to 65°C).

Optional (High Temperature Meter Clearances or

All Iron Trim) With:

Viton: 10°F to 200°F (-12°C to 93°C).

Teflon: -20°F to 200°F (-29°C to 93°C).

For other temperatures, consult factory.

#### Maximum Working Pressure

Standard: 150 psig (1,034 kPa) up to 200°F (93°C).

#### Meter Gearing

5 U.S. Gallons or 1 Dekalitre per revolution of meter calibrator output shaft.

## Pressure Drop ( $\Delta P$ )

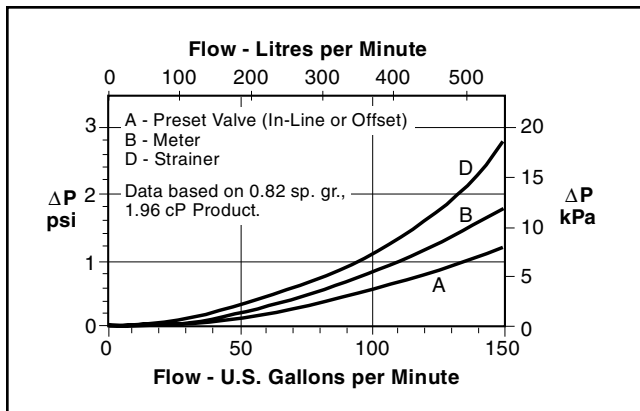

## Materials of Construction

	Housing	Internals	Seals
<b>Meter With Standard Trim</b>	Ductile Iron	Iron, Steel, Stainless Steel, Aluminum	Cover O-Ring Std. - Buna-N Opt'l. - Viton
<b>Meter With All Iron Trim</b>	Ductile Iron	Delete Aluminum From Standard	Packing Gland Std. - Buna Opt'l. - Teflon or Viton
<b>Strainers</b>	Steel	Steel, Stainless Steel	
<b>Preset Valves</b>	Ductile Iron	Steel, Iron, Ni-Resist	Std. - Buna-N Opt'l. - Viton EPR, or Teflon

## Installation

It is recommended that the meter be protected with a 40 mesh strainer.

## Dimensions

Inches (mm)

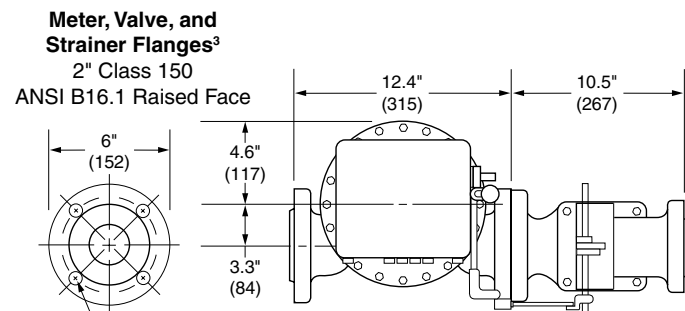

4 - 3/4" Bolt Holes equally spaced on a 4.8" (121) dia. bolt circle

**Meter Anchor Bolt Holes**  
3-3/8" - 16 Tapped Holes equally spaced on a 6.625" (168) dia. bolt circle.

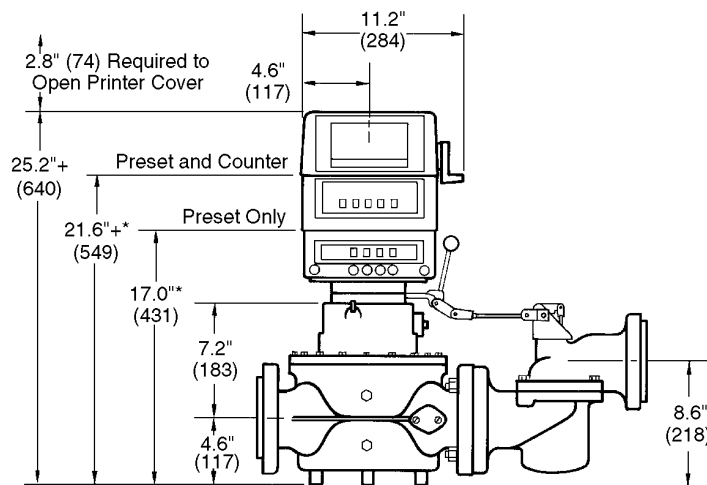
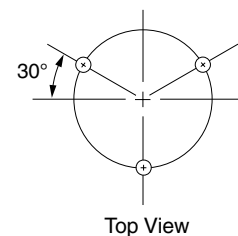

\*Includes Cover.

+Deduct 3.7" (94) if Preset Counter is not required.

**2" Model 22-E3 Steel Strainer**  
With Class 150 ANSI B16.1 Raised Face Flange

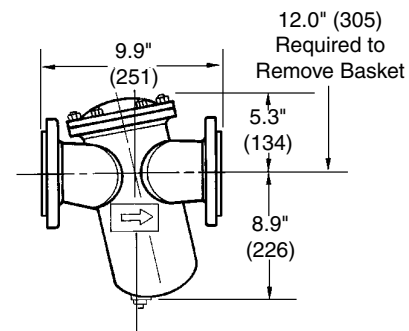

**Note:** Dimensions — Inches to the nearest tenth (millimetres to the nearest whole mm), each independently dimensioned from respective engineering drawings.

	Lb	Kg
Meter	97	44
2" Strainer Model 22-E3	25	11
Meter/LNC+	112	51
Preset Package+*	168	76

+ Add 10 lb. (4.5 kg) if ticket printer is required.

\* Includes Meter, LNC, Preset Counter and Valve.

3 Raised face flange is standard for ductile iron meter housing. Flat faced is optional and must be specified if it will mate with cast iron components.

## Ordering Information

<b>Application</b>	Batching, Loading, Blending, Inventory, Process Control, etc.
<b>Operating Conditions</b>	Liquid — Name and sp. gr., Flow Range <sup>4</sup> , Temp. Range <sup>4</sup> , Viscosity Range <sup>5</sup> , Maximum Working Pressure.
<b>Seals</b>	Meter: Buna <sup>5</sup> , Viton or Teflon. Valve: Buna <sup>5</sup> , Viton, EPR, or Teflon.
<b>Units of Registration</b>	Gallons, Litres, Pounds, Kilograms.
<b>Direction of Flow</b>	Left to right flow (as viewed from above) is standard and will be supplied unless right to left flow is specified.
<b>Options &amp; Accessories</b>	As required.

## Accessories

### Strainer

2" basket-type, Class 150 ANSI raised face flanges<sup>6</sup>.

### Mechanical Preset Valves

2" offset-type, ductile iron, Class 150 ANSI raised face flanges.

### Automatic Temperature Compensation

Model ATC - Factory-set for a given product.

Model ATG - Field-adjustable for different products.

### Counters

200 Series - Accumulative, 9-digit, non-reset type.

600 Series - 5 large-digit reset, 8 small-digit non-reset.

### Printer

Seven-digit accumulative.

Optional 6-digit zero start.

### Preset Counter

300C Series - 5-digit mechanical pushbutton preset with microswitch package for valve or pump control.

### Pulse Transmitters

LNC Pulse Transmitter (adapts to 600 Series Counters).

Low-Resolution - 1 or 10 pulses<sup>7</sup>.

High-Resolution (HR) - 50 or 100 pulses<sup>7</sup>.

UPT - Universal Pulse Transmitter - High resolution dual pulse quadrature output in a weather-tight explosion-proof enclosure (up to 1,000 pulses/rev.).

### Flow Rate Indicator

Direct mount mechanical.

Remote electronic.

### Remote Registration

Electromechanical counters.

Electronic totalizers.

<sup>4</sup> Specify: minimum/normal/maximum.

<sup>5</sup> Standard seals supplied unless optional material specified.

<sup>6</sup> Raised face flange is standard for ductile iron meter housing. Flat-Faced is optional and must be specified if it will mate with cast iron components.

<sup>7</sup> Per revolution of LNC right-hand wheel.

Revisions included in SS01005 Issue/Rev. 0.7 (6/08):  
Page 1: Added Extended Flow Turndown Feature.  
Page 3: Removed Type E - SPDT Mercury Wetted Switch Transmitter.

The specifications contained herein are subject to change without notice and any user of said specifications should verify from the manufacturer that the specifications are currently in effect. Otherwise, the manufacturer assumes no responsibility for the use of specifications which may have been changed and are no longer in effect.

---

**Headquarters:**

500 North Sam Houston Parkway West, Suite 100 Houston, TX 77067 USA, Phone: +1 (281) 260-2190, Fax: +1 (281) 260-2191

**Gas Measurement Products:**

Houston, TX USA +1 (281) 260-2190  
Thetford, England +44 (1842) 82-2900  
Kongsberg, Norway +47 (32) 286-700  
Buenos Aires, Argentina +54 (11) 4312-4736

**Integrated Measurement Systems:**

Corpus Christi, TX USA +1 (361) 289-3400  
Kongsberg, Norway +47 (32) 286-700  
San Juan, Puerto Rico +1809 (787) 274-3760  
United Arab Emirates, Dubai +971 (4) 331-3646

**Liquid Measurement Products:**

Erie, PA USA +1 (814) 898-5000  
Los Angeles, CA USA +1 (310) 328-1236  
Slough, England +44 (1753) 57-1515  
Ellerbek, Germany +49 (4101) 304-0  
Barcelona, Spain +34 (93) 201-0989  
Moscow, Russia +7 (495) 564-8705  
Melbourne, Australia +61(3) 9807-2818

Beijing, China +86 (10) 6500-2251  
Singapore +65 6861-3011  
Chennai, India +91 (44) 450-4400

**Visit our website at [www.fmctechnologies.com/measurementsolutions](http://www.fmctechnologies.com/measurementsolutions)**